

DETOUR PLAN

Scale: 1" = 1000'

As Reprinted From The CKS Engineers, Inc. GIS Data for West Rockhill Township, Bucks County, PA

SYMBOLS:
 DETOUR ROUTE
 AREA OF ROAD CLOSURE

- (A) TYPE B FLASHERS R11-3 60'x30' ROAD CLOSED 1000 FEET AHEAD LOCAL TRAFFIC ONLY
- (B) TYPE B FLASHERS R11-4 60'x30' ROAD CLOSED TO THRU TRAFFIC
- (L) TYPE B FLASHERS R11-4 48'x18' ROAD CLOSED TO THRU TRAFFIC
- (M) M1-5 30"x24"
- (N) W20-2 36"x36" W30-1-6 20"x6"
- (O) M1-5 30"x24"
- (P) W20-2 36"x36" W30-1-3 20"x6"
- (Q) M1-5 30"x24"
- (R) W20-2 36"x36" W30-1-2 20"x6"
- (S) M3-3 24"x12" M1-5 30"x24"
- (T) W20-2 36"x36" W30-1-3 20"x6"
- (U) M3-3 24"x12" M1-5 30"x24"
- (V) W20-2 36"x36" W30-1-3 20"x6"
- (W) M3-3 24"x12" M1-5 30"x24"
- (X) W20-2 36"x36" W30-1-2 20"x6"
- (Y) M3-3 24"x12" M1-5 30"x24"
- (Z) W20-2 36"x36" W30-1-2 20"x6"
- (UU) W20-2 36"x36" W30-1-2 20"x6"

- (C) DETOUR NORTH 563 M4-8 24"x12" M3-3 24"x12" M1-5 30"x24" M6-1 21"x15"
- (D) DETOUR NORTH 563 M4-8 24"x12" M3-3 24"x12" M1-5 30"x24" M5-1L 21"x15"
- (E) DETOUR NORTH 563 M4-8 24"x12" M3-1 24"x12" M1-5 30"x24" M6-1 21"x15"
- (F) DETOUR NORTH 563 M4-8 24"x12" M3-1 24"x12" M1-5 30"x24" M5-1R 21"x15"
- (G) END DETOUR NORTH 563 M4-8A 24"x12" M3-1 24"x12" M1-5 30"x24"
- (H) DETOUR SOUTH 563 M4-8 24"x12" M3-3 24"x12" M1-5 30"x24" M6-1 21"x15"
- (I) DETOUR SOUTH 563 M4-8 24"x12" M3-3 24"x12" M1-5 30"x24" M6-1 21"x15"
- (J) DETOUR SOUTH 563 M4-8 24"x12" M3-3 24"x12" M1-5 30"x24" M5-1L 21"x15"
- (K) DETOUR SOUTH 563 M4-8 24"x12" M3-3 24"x12" M1-5 30"x24" M5-1R 21"x15"
- (L) DETOUR SOUTH 563 M4-8 24"x12" M3-3 24"x12" M1-5 30"x24" M6-1 21"x15"
- (M) END DETOUR SOUTH 563 M4-8A 24"x12" M3-3 24"x12" M1-5 30"x24"
- (N) END DETOUR SOUTH 563 M4-8A 24"x12" M3-3 24"x12" M1-5 30"x24"
- (O) DETOUR NORTH 563 M3-1 24"x12" M1-5 30"x24"
- (P) DETOUR SOUTH 563 M4-9-1AR 30"x24" M3-3 24"x12" M1-5 30"x24"
- (Q) DETOUR NORTH 563 M3-1 24"x12" M1-5 30"x24"
- (R) DETOUR SOUTH 563 M4-9-1BR 30"x24" M3-3 24"x12" M1-5 30"x24"
- (S) DETOUR NORTH 563 M4-9-1AR 30"x24" M3-3 24"x12" M1-5 30"x24"
- (T) DETOUR SOUTH 563 M4-9-1BR 30"x24" M3-3 24"x12" M1-5 30"x24"
- (U) DETOUR NORTH 563 M4-9-1AR 30"x24" M3-3 24"x12" M1-5 30"x24"
- (V) DETOUR SOUTH 563 M4-9-1BR 30"x24" M3-3 24"x12" M1-5 30"x24"
- (W) DETOUR NORTH 563 M4-9-1AR 30"x24" M3-3 24"x12" M1-5 30"x24"
- (X) DETOUR SOUTH 563 M4-9-1BR 30"x24" M3-3 24"x12" M1-5 30"x24"
- (Y) DETOUR NORTH 563 M4-9-1AR 30"x24" M3-3 24"x12" M1-5 30"x24"
- (Z) DETOUR SOUTH 563 M4-9-1BR 30"x24" M3-3 24"x12" M1-5 30"x24"

- (H) ROAD CLOSED 500 FT W20-3 36"x36" W30-1-1 20"x6"
- (I) ROAD CLOSED 1000 FT W20-3 36"x36" W30-1-2 20"x6"
- (M) DETOUR NORTH 563 M4-8 24"x12" M3-1 24"x12" M1-5 30"x24" M6-3 21"x15"
- (O) DETOUR SOUTH 563 M4-8 24"x12" M3-3 24"x12" M1-5 30"x24" M6-3 21"x15"
- (N) CLOSED BETWEEN COUNTY LINE ROAD AND RIDGE VALLEY ROAD FOLLOW DETOUR 30' 60'

FREESIZED SIGNS
 **M1-5 45"x36"
 **M3-1 30"x15"
 **M3-3 30"x15"
 **M5-1L 30"x18"
 **M5-1R 30"x18"
 **M6-1 30"x18"
 **M6-3 30"x18"

LEGEND AND BORDER: BLACK, NON-REFLECTORIZED
BACKGROUND: ORANGE, REFLECTORIZED
LEGEND: 5" SERIES C, EACH LINE CENTERED
SIGN SP-7 DETAIL

- DETOUR NOTES:**
- THIS WORK CONSISTS OF THE DETOUR OF TRAFFIC AROUND THE CONSTRUCTION AREA.
 - CONTRACTOR WILL BE PERMITTED TO WORK FROM 9AM - 3PM. CONTRACTOR WILL ALSO BE PERMITTED TO WORK FROM 6PM - 6AM ALONG SPECIFIC PORTIONS OF THE ALIGNMENT WHERE APPROVED BY THE WEST ROCKHILL TOWNSHIP AND AUTHORITY AND FOLLOW ADEQUATE ADVANCED NOTICE TO PENNDOT.
 - ALL DISTANCES MAY BE ADJUSTED TO FIT FIELD CONDITIONS. THE ADJUSTMENTS ARE TO BE REVIEWED WITH THE ENGINEER PRIOR TO RELIGATION.
 - REGULATORY TRAFFIC CONTROL DEVICES SHALL BE MODIFIED AS NEEDED FOR THE DURATION OF THE DETOUR.
 - IF THE ROAD IS OPENED FOR SOME DISTANCE BEYOND THE INTERSECTION AND/OR THERE ARE SIGNIFICANT ORIGIN/DESTINATION POINTS BEYOND THE INTERSECTION, THE ROAD CLOSED (R11-3) AND DETOUR (M4-10L OR M4-10R, AS APPLICABLE) SIGNS ON THE TYPE III BARRICADES MAY BE LOCATED AT THE EDGE OF THE TRAVELED WAY.
 - UNLESS OTHERWISE SPECIFIED, ALL TRAFFIC CONTROL DEVICES FOR THE DETOUR SHALL BE FURNISHED, ERECTED, MODIFIED, MAINTAINED, AND SUBSEQUENTLY REMOVED BY THE CONTRACTOR FOR CONTRACT OPERATIONS.
 - ALL DETOURS INVOLVING STATE-DESIGNATED HIGHWAYS SHALL HAVE THE PRIOR APPROVAL OF THE DEPARTMENT, AND ALL DETOURS INVOLVING LOCAL HIGHWAYS SHALL HAVE THE PRIOR APPROVAL OF THE APPROPRIATE LOCAL AUTHORITIES.
 - NOTIFY PADOT PRESS OFFICE TWO (2) WEEKS PRIOR TO CLOSURE.
 - COVER ALL DETOUR SIGNS WHEN DETOUR IS NOT IN EFFECT.
 - DETOUR SHALL BE IN EFFECT DURING ALL CONSTRUCTION WITHIN ROADWAY.
 - THIS TRAFFIC CONTROL PLAN DOES NOT RELIEVE THE CONTRACTOR OF HIS RESPONSIBILITY AS SPECIFIED IN SECTION 901.39(a) OF PUBLICATION 408/2020.
 - ALL TRAFFIC CONTROL DEVICES SHALL BE NEW OR IN LIKE NEW CONDITION AND MAINTAINED AS SUCH.
 - ALL WARNING SIGNS FOR THE PROJECT ARE TO BE OF TYPE III FLORESCENT OR TYPE VII FLORESCENT SHEETING. LOCATION OF ALL SIGNS ARE TO MEET CURRENT STANDARDS FOR OFFSET, MOUNTING HEIGHT, AND BE PROPERLY BALLASTED.
 - ALL POST MOUNTED SIGNS MUST BE MOUNTED ON BREAKAWAY STEEL POST AS SPECIFIED IN SECTION 1103.08 OF POT PUBLICATION 408/2020 CURRENT VERSION.
 - NOTIFY THE PROJECT REPRESENTATIVE AND THE DISTRICT HAULING PERMIT OFFICE (610)205-6787 IN WRITING VIA A COMPLETED M937R FORM, AT LEAST 14 DAYS BEFORE IMPLEMENTING OR CHANGING ANY LATERAL LANE RESTRICTION, WHICH PROVIDES LESS THAN 16 FEET OF PAVEMENT AND SHOULDER IN EACH DIRECTION FOR OVERSIZE VEHICLE, INCLUDING A DETOUR. NOTIFY THE REPRESENTATIVE, IN WRITING, AT LEAST 7 DAYS BEFORE REMOVING THE RESTRICTION.

- MAINTENANCE AND PROTECTION OF TRAFFIC NOTES:**
- THE CONTRACTOR MUST MAINTAIN ACCESS TO ALL BUSINESSES AND PROPERTIES WITHIN THE WORK ZONE.
 - ALL WORKERS SHALL FOLLOW THE REGULATIONS SET FORTH IN TITLE 23 OF THE CODE OF FEDERAL REGULATIONS 9CFR PART 634 EFFECTIVE NOVEMBER 24, 2008 IN REGARDS TO WORKER'S SAFETY APPAREL.
 - ALL SIGNING MUST CONFORM TO PUB 213 AND PUB 236.
 - CONTRACTOR MUST NOTIFY THE DISTRICT 6-0 PRESS OFFICE 610-205-6800 ON THURSDAY OF THE WEEK PRIOR TO COMMENCING WORK. FILL OUT THE PRESS RELEASE ONLINE AT: penndot.gov/district6/roadrestrictionform
 - NOTIFY THE DISTRICT 6-0 REGIONAL TRAFFIC MANAGEMENT CENTER (RTMC) 610-205-6934 FIFTEEN (15) MINUTES IN ADVANCE OF ANY PROPOSED LANE OR SHOULDER RESTRICTION, ROAD CLOSURE, OR ANY OPERATION IMPEDING THE FLOW OF TRAFFIC. NOTIFY THE RTMC WHEN THE ROAD IS RESTORED TO NORMAL OPERATION.
 - NOTIFY THE LOCAL EMERGENCY OFFICIALS (POLICE, FIRE AND AMBULANCE), SEPTA (IF A BUS ROUTE), POST OFFICE AND SCHOOL DISTRICT (DURING SCHOOL YEAR) 2 WEEKS PRIOR TO ALL DETOURS.
 - THE CONTRACTOR MUST COORDINATE WITH ANY OTHER ROAD WORK THAT IS OCCURRING IN THE AREA.
 - THE WORK MUST BE PERFORMED IN A WAY THAT WILL NOT CREATE A HAZARD FOR VEHICLE TRAFFIC OR PEDESTRIAN TRAFFIC.

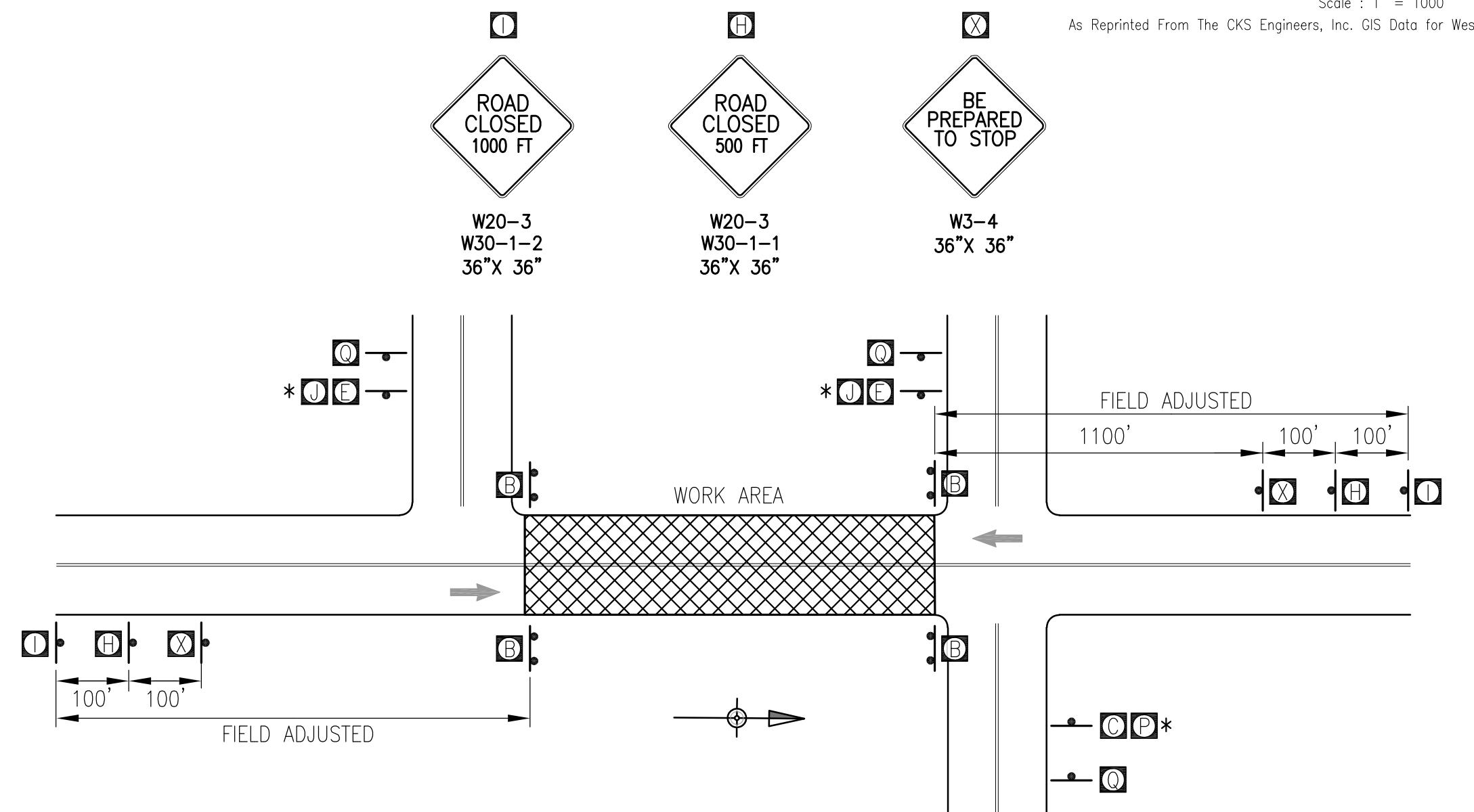

- NOTES:**
- THE CONTRACTOR SHALL PERFORM THIS OPERATION IN SEGMENTS, WHERE ROAD CLOSURES OCCUR IN BETWEEN TWO ADJACENT INTERSECTIONS. PATAS 109 AND 110 SHALL BE USED WHEN OPERATIONS DO NOT MEET THE AFOREMENTIONED REQUIREMENTS.
 - * SIGNS SHALL ALTERNATE AS NEEDED TO DETOUR TRAFFIC AWAY FROM ONGOING WORK.

WORK AREA SIGNAGE
 (SIGNS MOVE WITH WORK AREA)

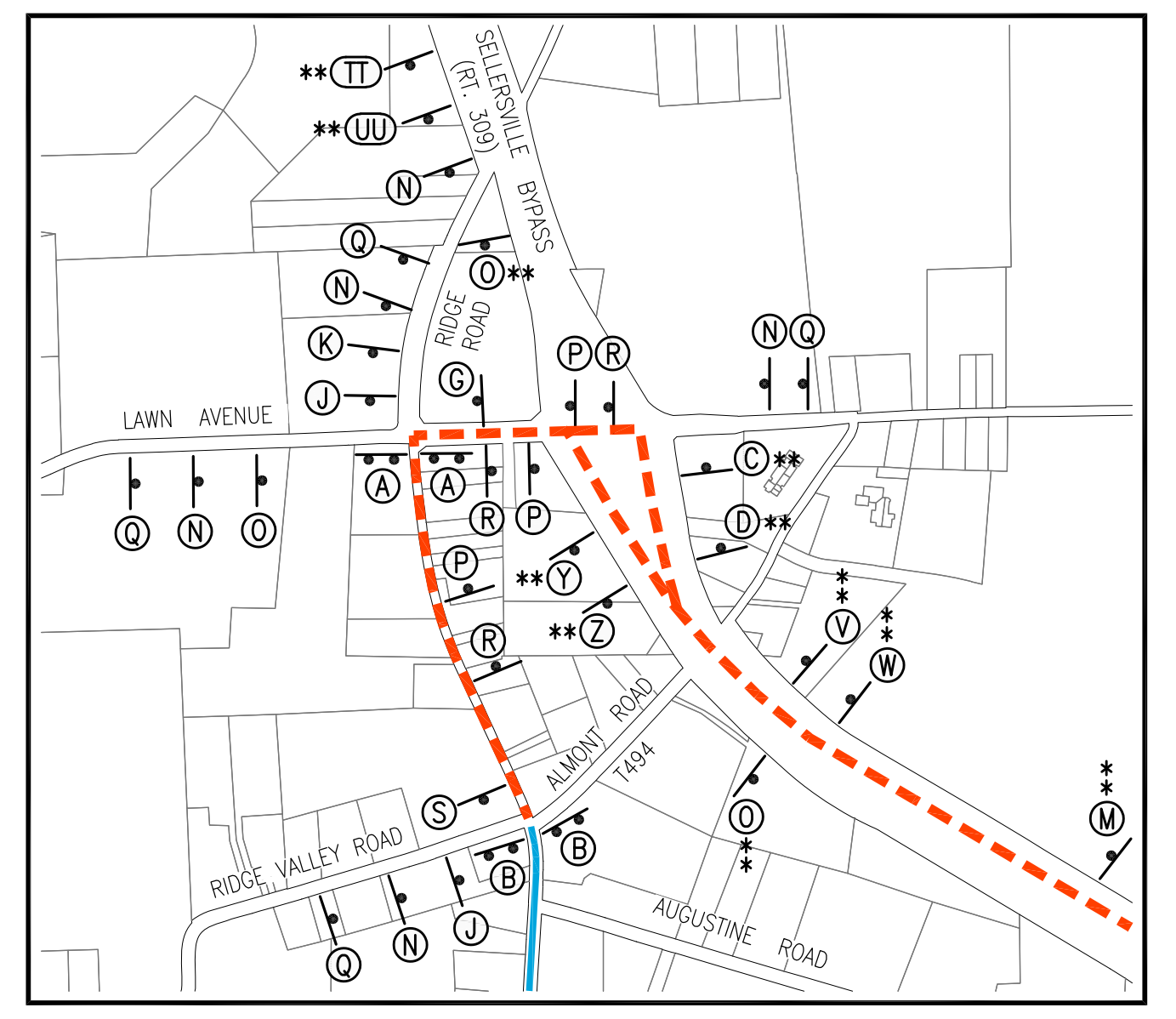

DETAIL 'A'
 Scale: 1" = 600'
 ** THE SIGNS ON RT. 309 MUST BE THE FREESIZED SIGNS

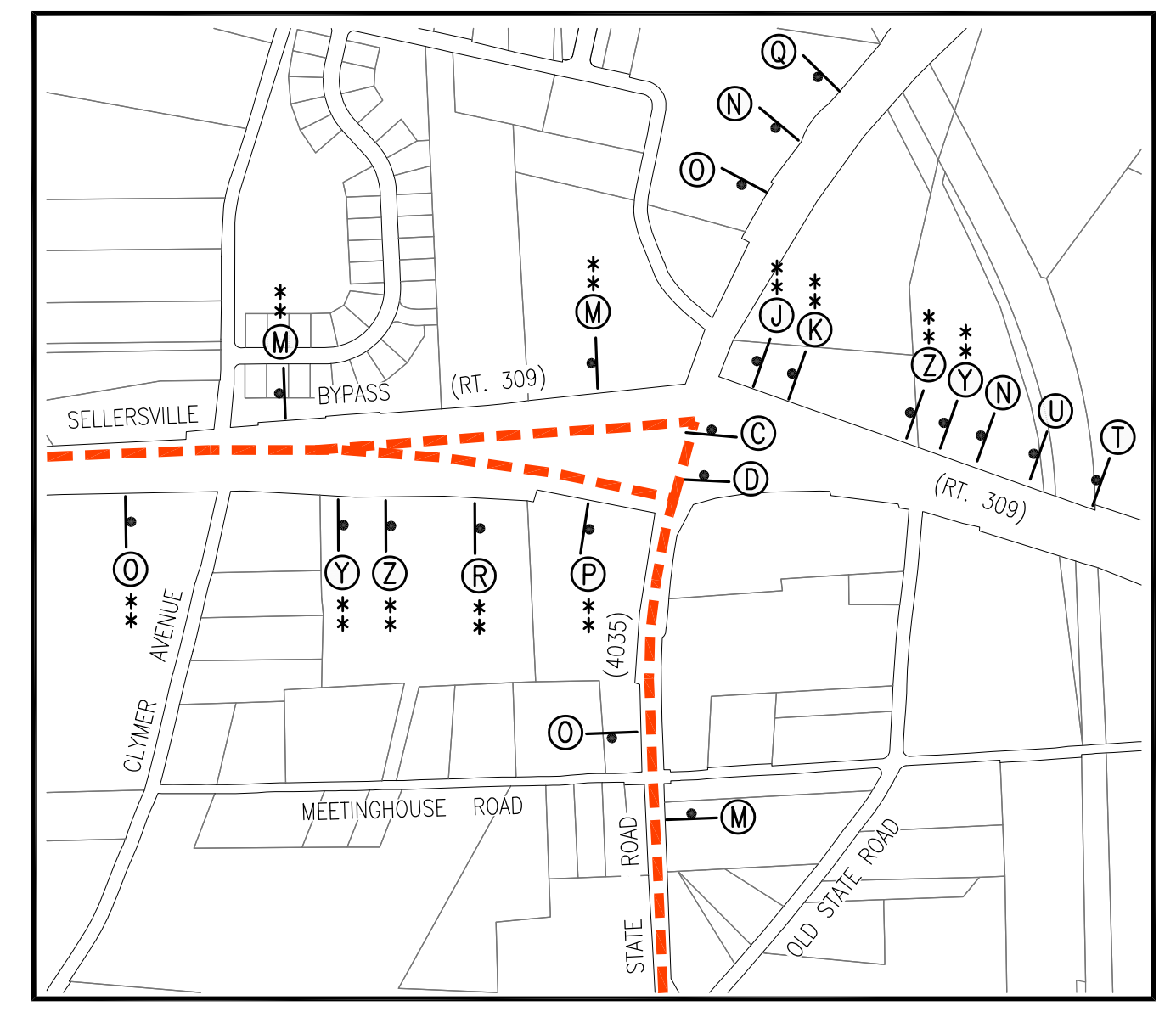

DETAIL 'B'
 Scale: 1" = 600'
 ** THE SIGNS ON RT. 309 MUST BE THE FREESIZED SIGNS



2	10/3/23	As Per PennDOT Review
1	8/30/23	As Per PennDOT Review
Rev. No.	Date	Description
DETOUR PLAN		
NORTH PENN WATER AUTHORITY WEST ROCKHILL WATER TRANSMISSION MAIN PROJECT		
West Rockhill Township		Bucks County, Pennsylvania
Date:	Scale:	Drawn By: CJ
6/9/23	AS SHOWN	Checked By: MFG
10159		25 OF 25